

KEYHOLE FENDERS

The Rubber Company's keyhole fenders are specially designed for Tug and Work boats, they are made of high abrasion resistance rubber with excellent resilience properties for the required application. These fenders are very tough but can be curved around the hull allowing fixing of this product to be very simple.

Key Features:

- Heavy duty design
- Curves around bends
- Easy installation

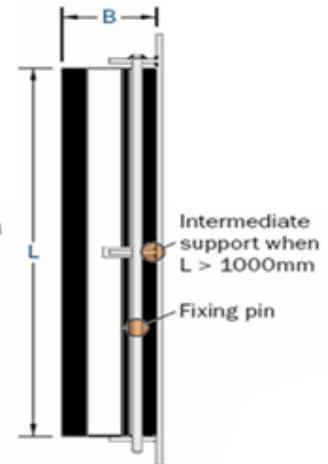
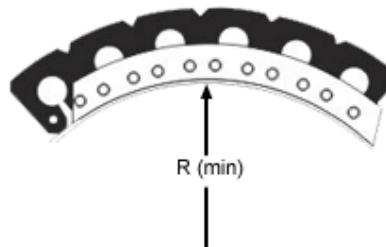
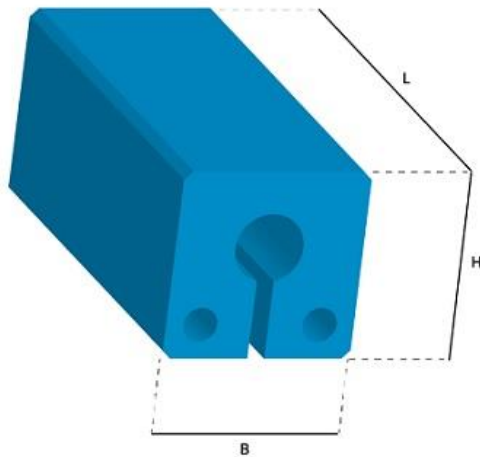

Product Reference	B x H mm	Pin Dia. mm	Flat Bar mm	R min	L Max. mm
TRC-KH200	200 x 200	25	100 x 15	450	2000
TRC-KH250	250 x 250	30	125 x 20	600	2000
TRC-KH300	300 x 300	30	150 x 20	800	2000
TRC-KH350	350 x 350	30	175 x 25	1000	2000
TRC-KH400	400 x 400		200 x 25	1200	2000

E: sales@therubbercompany.com W: www.therubbercompany.com